

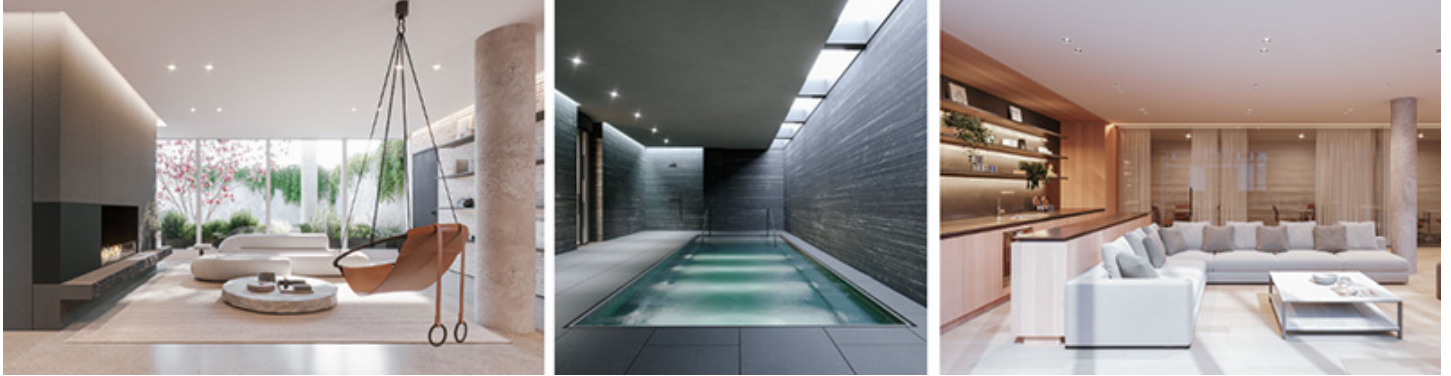

## DXA Studio brings wellness living to 110 North 1st St.

July 25, 2023 - Design / Build



Brooklyn, NY EDRE Development has launched sales at 110 North 1st St. in Williamsburg. Offering one- to four-bedroom condominiums, the project is bringing high-end residential living to North 1st St. With a base building designed by EDRE Development and interiors by DXA Studio, the seven-story, 38-unit building offers residences with a suite of amenities focused on health and wellness.

“110 North 1st St. is a fully amenitized, luxury experience in the heart of Williamsburg, a building that is completely realized with wellness at the heart of its design and architecture,” said Harel Edery, founder EDRE Development.

In designing the interiors of 101 North 1st St., DXA Studio made wellness and health the central tenet of the project. All residences throughout 110 North 1st has oversized windows and terraces, showing the importance of a life full of fresh air and bright light. The interiors are created with a bright material palette, featuring wide plank white oak floors, and ceramic and marble tiles and counters. With a range of residences, including garden residences with outdoor space, two-to-three bedrooms residences, floor-through homes, and penthouses, each home offers a unique living experience.

“The interiors and amenities at 110 North 1st St. prioritize the holistic wellbeing of the building’s residents,” said Jordan Rogove, partner at DXA Studio. “The last several years in our culture have clarified the importance of home – and the possibility of spending a lot of time in your home – and we wanted to create a building that was a tranquil respite in every way.”

Wellness is also centerstage in the amenity package offered to all residents. The building features a full floor of amenities that includes a fully equipped gym, a full-service spa, and a room for children

to make and create. The spa will include a salt meditation room, a sauna, hot tub, and a plunge pool – all designed to help residents decompress and feel relaxed every moment of their time at home.

110 North 1st St. incorporates features that enhance the everyday and simplify complexities. Upon entering the ground floor, you will find three contiguous spaces: The Lobby, The Library, and The Lounge. The lobby is adorned with double height ceilings composed of textured mashrabiya that relates to the woven exterior façade by EDRE. The spaces providing owners with a place to gather and work remotely – complete with seating suspended from the ceiling, a fireplace, and a bar.

An extension to the beautifully designed interiors is the roof terrace. Designed to allow residents to extend their life from indoors to a fully focused outdoor experience with panoramic views of the East River and Manhattan skyline. The rooftop terrace has been beautifully landscaped and designed with shared spaces and private cabanas available to those that own a penthouse residence. All residents are offered shared spaces feature dining tables, lounge chairs, and a summer kitchen with barbecue grills.

A collection of dedicated spaces, personal service, and residential technology combine to make everyday living in the urban context more effortless and enjoyable including a pet spa with stone shower, rooftop dog run, bike storage room, and onsite parking garage.

The building is located on North 1st between Wythe and Berry, among Brooklyn's most desirable residential blocks. Williamsburg has evolved into one of Brooklyn's most exciting and well-rounded waterfront neighborhoods – with the beautifully imagined Domino Park along the East River, luxury shopping and a delightfully eclectic array of dining options, it offers the ultimate upscale urban lifestyle.

Sales and marketing are being handled by The Shemesh Team and The Masters Division at Nest Seekers International.

New York Real Estate Journal - 17 Accord Park Drive #207, Norwell MA 02061 - (781) 878-4540